

# ADVANCE ADAPTERS INC.

P.O. Box 247, 4320 Aerotech Center Way

Paso Robles, CA 93447

Telephone: (800) 350-2223 Fax: (805) 238-4201

P/N: 716316

PAGE 1 OF 1

Page Rev. Date: 07-15-94

## LARGE LAND CRUISER RELEASE BRG. FOR USE WITH STANDARD CHEVY T/O ARM

### KIT CONSISTS OF:

<u>No.</u>	<u>Qty</u>	<u>Part No.</u>	<u>Description</u>
1.	1	716175	SPECIAL STEEL COLLAR (**Assembled with bearing)
2.	1	716314	LARGE TOYOTA RELEASE BEARING

### NOTES:

This bearing collar and release bearing are designed for specific use with the Chevrolet cast iron throw out arm, Advance Adapter Part No. 716176. By using this bearing assembly with the GM bellhousing, you will be able to take advantage of the large diameter fitting against the Chevy pressure plate. This same bearing is used in all of the Toyota 4 speed conversion kits and, up until July of 1994, could not be used with other applications. Prior to this time, the customer would use the smaller diameter GM Part No. N1086. This bearing assembly can be used with Land Cruiser installations that are equipped with the SM420, SM465, and Muncie 4 speed transmissions. The real advantage to this bearing is that it generates a better mechanical advantage requiring less travel of the Toyota slave cylinder for full pressure plate release. The new bearing assembly will only fit GM transmission bearing retainers.

If you are using this large bearing with a Centerforce pressure plate, you must check to make sure that the wire that controls the Centerforce weights will not come in contact. The Advance Adapter pressure plate, Part No. CF165473S, has been equipped with a larger wire diameter that allows clearance for the bigger bearing.

LARGE TOYOTA RELEASE BEARING  
PART #716314

THROW OUT BEARING COLLAR  
PART #716175

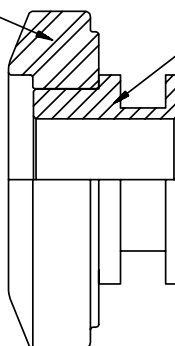

**SPECIAL NOTE:** The components packaged in this kit have been assembled and machined for specific type of conversions. Modifications to any of the components will void any possible warranty or return privileges. If you do not fully understand modifications or changes that will be required to complete your conversion, we strongly recommend that you contact our sales department for more information. This instruction sheet is only to be used for the assembly of Advance Adapter components. We recommend that a service manual pertaining to your vehicle be obtained for specific torque values, wiring diagrams and other related equipment. These manuals are normally available at automotive dealerships and parts stores.