



P.O. Box 247, 4320 Aerotech Center Way  
Paso Robles, CA 93447  
Telephone: (800) 350-2223 Fax: (805) 238-4201  
PAGE 1 OF 2      Page Rev. Date: 09-11-25  
P/N: A27-AOD

KIT CONSISTS OF:

No.	Qty	Part No.	Description
1.	1	300120A	SHAFT- ATLAS INPUT 27T LONG
2.	1	300107A	RETAINER- ATLAS INPUT TO BRONCO 5" INDEX
3.	6	723731	BOLT 3/8 -16 X 1.00" SHCS ZINC
4.	1	300500	SEAL-INPUT SHAFT ATLAS

Applications that have previously installed AA, 50-2704E kit.

AA 51-2703, AOD AT Adapter Housing

AA 52-2705E, 27-Spline AODE AT (Output Shaft)

ATLAS Transfer Case, Clocked 41 Deg. as shown below  
(Replacing DANA 20 Transfer Case)

The Atlas can be rotated higher, however, it may require some clearance on the frame.

**SPECIAL NOTE:** The components packaged in this kit have been assembled and machined for specific type of conversions. Modifications to any of the components will void any possible warranty or return privileges. If you do not fully understand modifications or changes that will be required to complete your conversion, we strongly recommend that you contact our sales department for more information. This instruction sheet is only to be used for the assembly of Advance Adapter components. We recommend that a service manual pertaining to your vehicle be obtained for specific torque values, wiring diagrams and other related equipment. These manuals are normally available at automotive dealerships and parts stores.

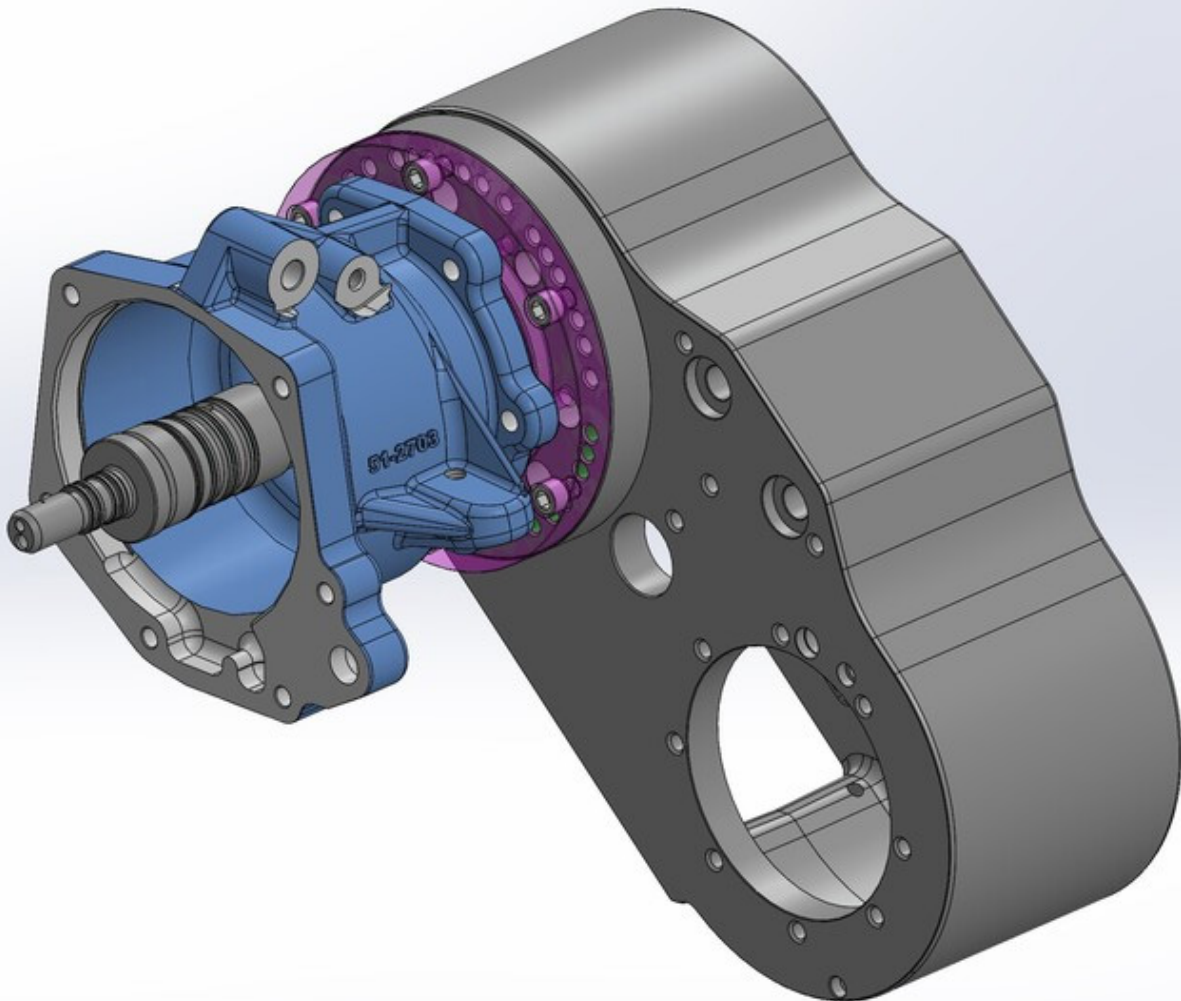

**SPECIAL NOTE:** The components packaged in this kit have been assembled and machined for specific type of conversions. Modifications to any of the components will void any possible warranty or return privileges. If you do not fully understand modifications or changes that will be required to complete your conversion, we strongly recommend that you contact our sales department for more information. This instruction sheet is only to be used for the assembly of Advance Adapter components. We recommend that a service manual pertaining to your vehicle be obtained for specific torque values, wiring diagrams and other related equipment. These manuals are normally available at automotive dealerships and parts stores.